

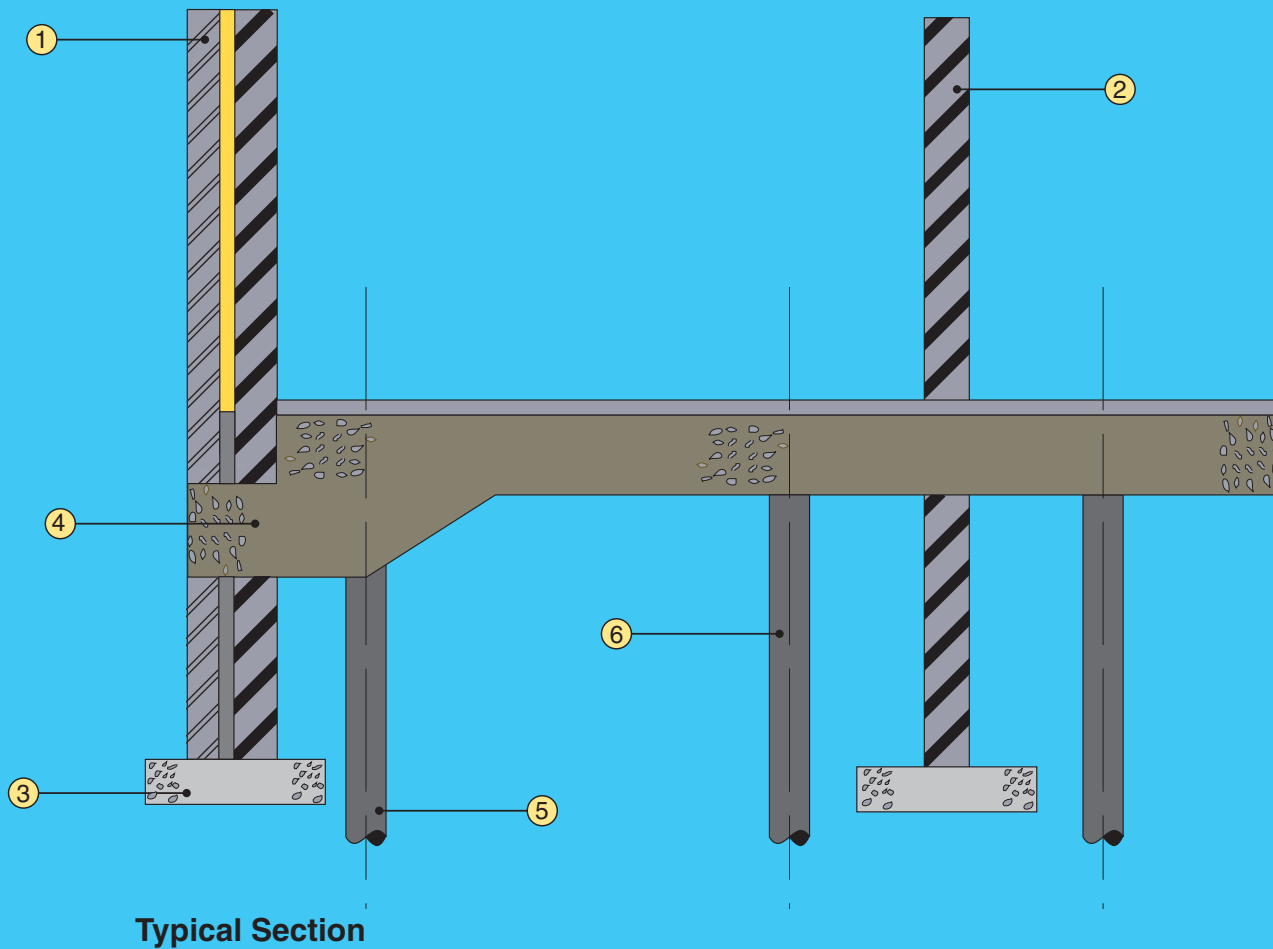

TECHNICAL INFORMATION

Piled Slab Underpinning

- ① External wall.
- ② Internal wall.
- ③ Existing foundation.
- ④ Intermittent nib cast into wall.
- ⑤ Piles at close centres to carry external wall loading.
- ⑥ Piles on integral grid matrix to carry slab and internal walls.



General Information

The provision of a new reinforced concrete floor slab nibbed into the existing walls of a structure, supported on piles is often used when underpinning a complete structure.

Anvil Foundations Limited

5300 Lakeside
 Cheadle Royal
 Cheadle
 Business Park
 Cheshire
 SK8 3GP

T 0161 246 6055
 F 0161 246 6100
 E info@minipiling.co.uk
 W www.pilingUK.com



INVESTOR IN PEOPLE